



1 BASKETBALL COURT



2 OPEN SPACE TURF AREA (.78 ACRES)



3 RESTROOM BUILDING



4 HOA POOL



5 GROUP RAMADA

POD 6-4  
KB HOME  
ZONING-PC

POD 6-1  
KB HOME  
ZONING-PC

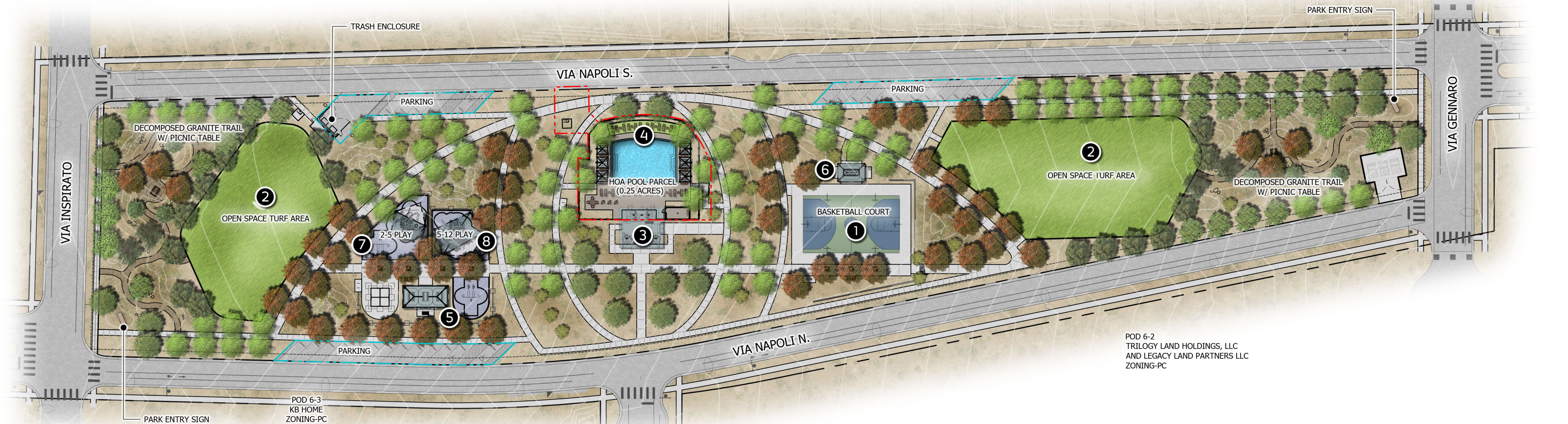

POD 6-2  
TRILOGY LAND HOLDINGS, LLC  
AND LEGACY LAND PARTNERS LLC  
ZONING-PC



6 RAMADA

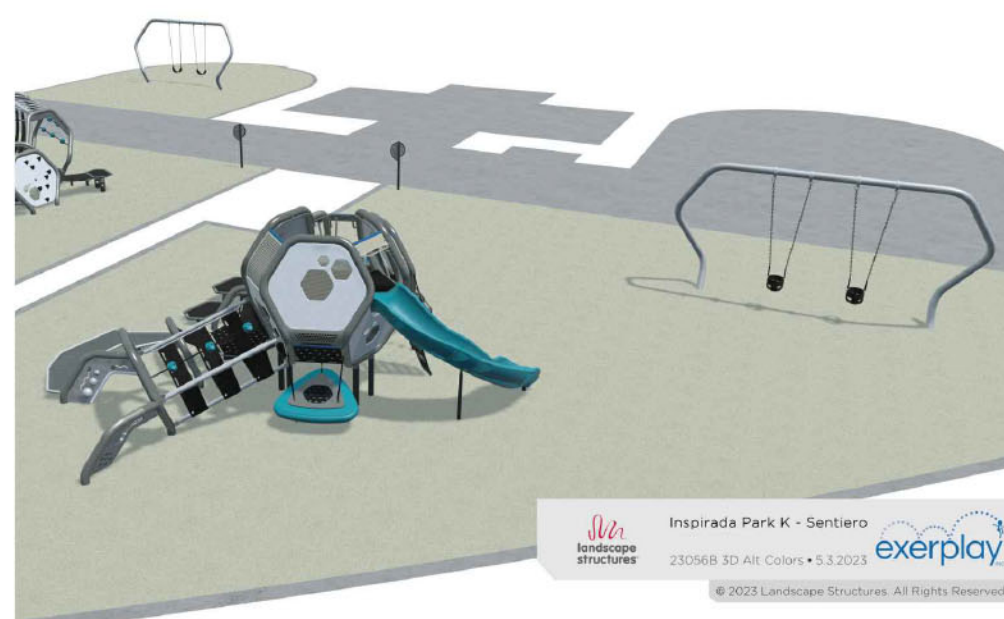

7 TOT LOT (AGES 2-5)

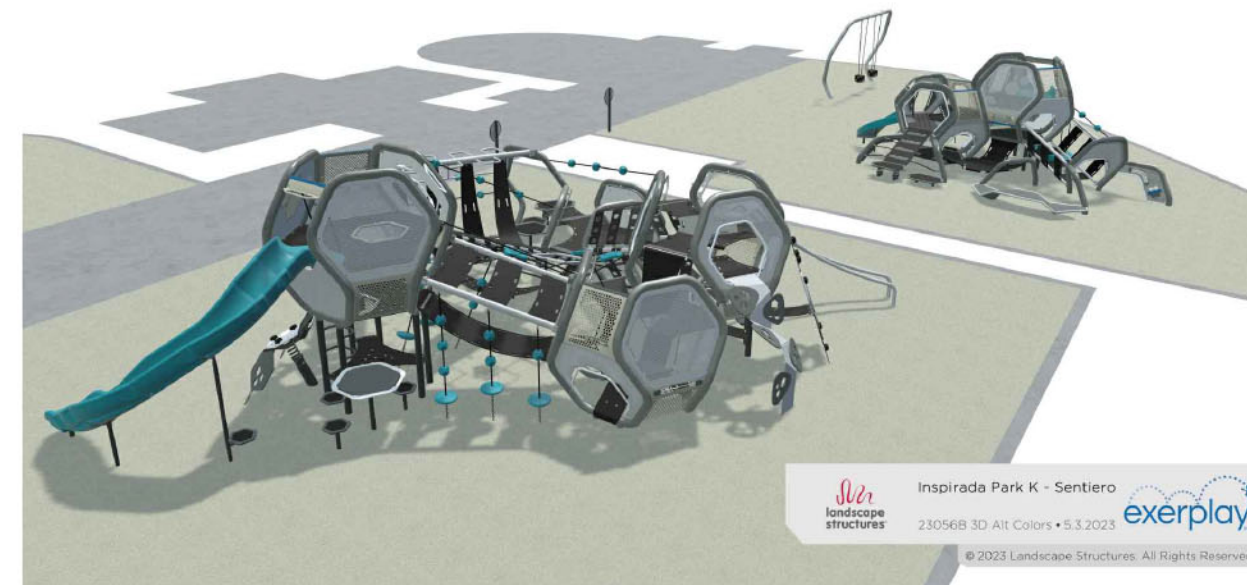

8 TOT LOT (AGES 5-12)

PROPERTY / INFORMATION:

PARCEL: 191-22-411-003  
OWNER NAME: INSPIRADA BUILDERS, LLC  
ESTIMATED LOT SIZE: 5.18 AC  
ZONING CLASSIFICATION: PLANNED COMMUNITY (PC)  
PLANNED LAND USE: INCORPORATED CLARK COUNTY (INCOMP)

SOURCE: gisgate.co.clark.nv.us

DISCLAIMER:  
THE DEVELOPER HAS RESERVED THE RIGHT, WITHOUT NOTICE, TO MAKE CHANGES TO THIS PLAN AND OTHER ASPECTS OF THE DEVELOPMENT AT ANY TIME, INCLUDING BUT WITHOUT LIMITATION TO COMPLY WITH GOVERNMENTAL REQUIREMENTS AND TO FULFILL ITS MARKETING OBJECTIVES. ALL OF THE ITEMS SHOWN ON THIS PLAN NEED TO BE BUILT PURSUANT TO NEVADA REVISED STATUTES.

PARK K TOTALS

PARK ACRES: 4.8 AC  
HOA POOL: 0.25 AC  
PARKING AREA: 0.2 AC  
TOTAL NET ACRES: 5.25 AC  
BUILDING SIZE: 1,100 SF  
BUILDING COVERAGE: 0.48%

PARK K PARKING PROVIDED:

ACCESSIBLE: 27  
ADA ACCESSIBLE: 3  
TOTAL:30



Vicinity Map Not To Scale



SENTIERO PARK  
Overall Site Plan

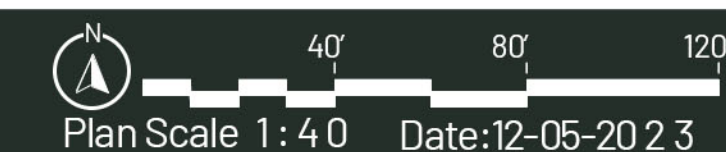

ABLSTUDIO.COM

